

Whale - Electric Bilge Pump Range

From the Experts in Bilge Pumps
experience in electronics



Leaders in bilge pumps for more than 60 years

- Award winning new automatic pumps
- Narrow low profile pumps ideal solutions ideal for confined bilges
- Latest Intelligent Control technology

Automatic Electric Bilge Pump Range

No separate electric bilge switch needed



- Whale Supersub Smart - Narrow low profile automatic submersible pumps - Page 12-13
- **NEW** Orca Auto - Compact, powerful and automatic high capacity submersible pump - Page 14-15
- **NEW** Bilge IC - Remote mount complete automatic system - Page 16-17

Standard Submersible Bilge Pump Range

For use with separate electric bilge switch

- Supersub Standard - Narrow low profile submersible pumps - Page 18-19
- **NEW** Orca compact and powerful submersible pumps widest range Page 20-21
- **NEW** Orca high capacity models - Page 20-21
- Gulper® 320 - Remote mounted bilge pump - Page 22-23

Accessories

Complete the system with electric bilge switches, non-return valves, pipework fittings - Page 40-43

Supersub Smart Family



Low profile automatic bilge pumps sense bilge water level and switch on and off automatically

Fit deep down in confined bilge areas, under engines or cockpit floors



650



NEW 1100

NEW Widest Range Ever



Product code: see table



- **Sailing Today**
– Premium Product Award August 2009
“This was our all round favourite pump with multiple installation options easily cleaned and removable filter, small bore hose and full automation.”
James Turner
Sailing Today Group test - August 2009
- “This pump is easily the best working pump I have ever owned. I will recommend your company as I often service many boats.”
Mr Ekberg, Boat Servicing Customer, Sweden
June 2011

See more Supersub products on page 18

*Not included in SS5212 model

Features and Benefits

WHY Supersub Smart?

- Fits deep in the bilge where other pumps can't reach
- No separate bilge switch required
- Automatically controlled patented electric field sensor detects water level
- Waterproof electronics- protected against water ingress
- Quick and easy installation - long wires, strainer and outlet rotate to suit your bilge area
- Unaffected by wave motion
- Environmentally friendly - mercury free
- Includes manual override facility
- Solid state switching - no moving parts

1 Year Warranty

Tips

- Easy clean
 - unique clever strainer design
 - easy to remove and replace for cleaning

Awards and Accreditations

- Qualtec award
 - Menzione Speciale 2009
- NMMA Innovation Award
 - Honourable Mention 2009



Approvals and Standards

- Conforms to ISO 8849 and ISO 15083
- Ignition protected per ABYC and USCG standards
- NMMA type accepted



Product Information



Model Specifications

Model Product Code	Supersub Smart - Low Profile Automatic Bilge Pump			
	SS5212	SS5222 With non-return valve	SS1212 With non-return valve	SS1224 With non-return valve
Open Flow Rate @ 13.6 V d.c.	650 GPH (40 ltrs/min)		1050 GPH (66 ltrs/min)	1050 GPH (66 ltrs/min)
Flow Rate @ 1m Head	550 US GPH (34 ltrs/min)		750 GPH (47 ltrs/min)	750 GPH (47 ltrs/min)
Nominal Voltage	12 V d.c.		12 V d.c.	24 V d.c.
Current Draw	3.4 Amps		5 Amps	2.2 Amps
Recommended Fuse Size	5 Amp automotive		5 Amp automotive	2.5 Amp automotive
Wire Size (Caulked Wire)	1.5mm (16 AWG)		1.5mm (16 AWG)	1.5mm (16 AWG)
Weight	0.326 kg (0.71 lbs)		0.45 kg (0.99 lbs)	0.45 kg (0.99 lbs)
Maximum Discharge Head	3m (10ft)		3m (10ft)	3m (10ft)
Hose Connections	19mm (3/4")	25 / 28mm (1" - 1 1/8") Stepped port	25 / 28mm (1" - 1 1/8") Stepped port	25 / 28mm (1" - 1 1/8") Stepped port
Materials	Pump Body; polypropylene, high temperature ABS, fully potted circuitry. Locking Ring; acetal, Impeller; Glass filled polypropylene Seals; Nitrile®, Fasteners; stainless steel.			
Overall height	75mm (3")		75mm (3")	
Overall Width	54mm (2 1/8")		54mm (2 1/8")	
Overall Length	212mm (8 3/8")		240mm (9 1/2")	

Note: For wiring advice on your installation, please contact Whale.

These specifications are retail items only.

For details of our bulk pack range for boat builders and wholesalers - contact Whale Support.

Flow rates quoted are based on Whale laboratory tests without a non-return valve included.

Typical Installations

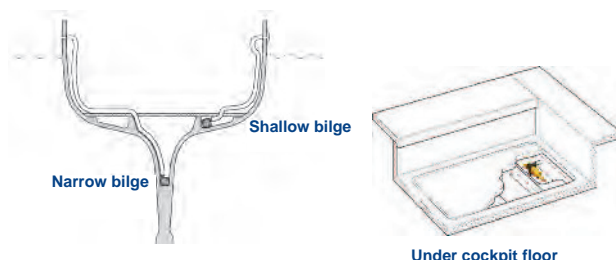

COMPLETE YOUR SYSTEM

Whale high quality bilge accessories including non-return valves (LV1219 for use with SS5212 model only) elbows and y pieces. Page 40-43

YOU MAY ALSO LIKE

NEW Orca Auto 1300 – page 14

NEW Bilge IC - Pre-wired Remote Mounted Bilge System with automatic intelligent control built in - page 16

NEW Grey IC and Gulley IC
– Automatic Grey Waste systems
– pages 86 and 88

DIMENSIONS FOR 650 MODEL

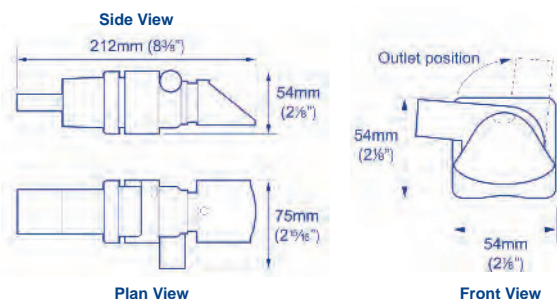

DIMENSIONS FOR 1100 MODEL

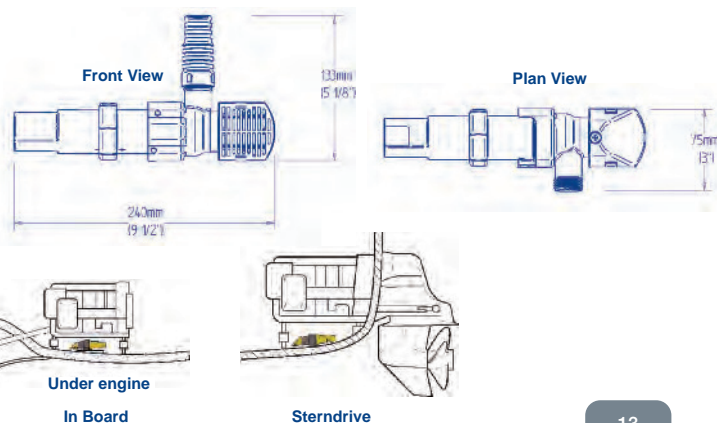

Orca Auto 1300



NEW Compact, powerful and automatic

Submersible bilge pump with large footprint to ensure maximum surface area exposure to bilge water - no separate bilge switch required!

Integrated Electronics
Fully potted IC built in intelligent control.
Microprocessor electronics sealed for protection against water ingress

Fully Protected
Robust housing made from fuel resistant ABS

Easy Install
25mm (1")
28mm (1 1/8")
stepped
connection
ports to suit
your installation

Efficiency
Large surface area ensures maximum area exposed to bilge water

Product code: see table

Features and Benefits

WHY ORCA AUTO 1300?

Introducing Whale's latest addition to our intelligent automatic electric bilge pump range

- High performance - 1300 US gals/hr flow rate
- Simple to install - built in automatic sensor
- No separate bilge switch is required
- Long battery life - low amp draw
- Neat fit in compact bilge areas
- ABS fuel - resistant housing
- Efficient - large filter ensures maximum surface area exposed to bilge water

1 Year Warranty

Awards and Accreditations

- Conforms to ISO 8849
- CE certified

COMPLETE YOUR SYSTEM

Bilge system accessories including non -return valves, elbows and y pieces. Page 40-43

YOU MAY ALSO LIKE

Supersub Smart

– Narrow low profile automatic electric bilge pumps – page 12

Bilge IC

– The remote mounted pre-assembled bilge pump kit with Intelligent Control built in – page 16



Product Information



Model Specifications

Product Code	NEW Whale Orca Auto 1300	
	BE1482	BE1484
Nominal Voltage	12 V d.c.	24 V d.c.
Open Flow Rate @13.6 V d.c.	1300 US GPH (82 l/min)	1300 US GPH (82 l/min)
Flow rate at 1m (3ft) head	1100 GPH (65 l/min)	1100 GPH (65 l/min)
Current Draw	5 Amps	2.5 Amps
Recommended Automotive Fuse Size	7.5 Amp	5 Amp
Weight	0.9 kg (2lbs)	
Hose Connection	Stepped ports 1" and 1 1/8"	
Wire Size	16 AWG x 1m (3ft)	
Maximum Discharge Head	4.5m (14.8ft)	
Overall Height	129mm (5.1")	
Overall Width	168mm (6.6")	
Overall depth	121mm (4.8")	
Materials	Pump Body- ABS, Seals: Nitrile®, Impeller: Acetal	

Note: For wiring advice on your installation, please contact Whale.

These specifications are retail items only. For details of our bulk pack range for boat builders and wholesalers - contact Whale Support

Registered design 000672216

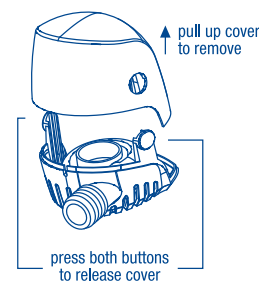

Easy maintenance

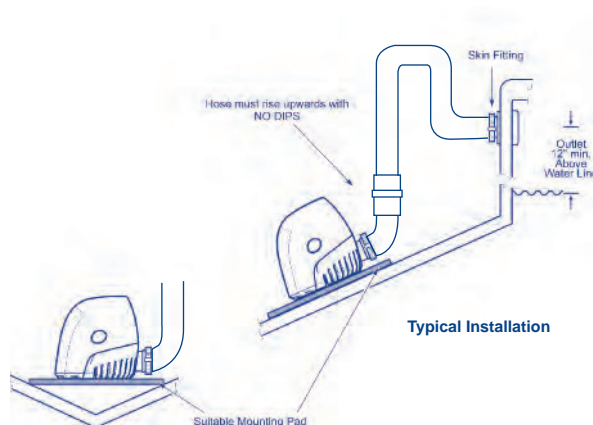

Typical Installation

Bilge IC



NEW Pre-wired Easy Access Remote Mounted Bilge System (4 in 1) with automatic intelligent control built in

Save time and money by reducing four separate components to one pre-wired system. Remote mounting automatic Gulper IC receives signals from Strainer IC and switches on and off automatically



COMPLETE 4 in 1 PRE-WIRED SYSTEM

Complete your system intelligent pump, strainer, non return valve and intelligent digital switch in one

Product code: see table

3 feet design
- Only 3 screws to fit

Features and Benefits

WHY Bilge IC?

- Pre-wired and assembled - just connect power
- Remote mounted pump for easy inspection
- Soft start - protects the pump for long life
- Small footprint strainer fits into very confined bilge spaces
- Low current controlled switching - no switch failure from high currents
- On/off delay - prevents cycling
- Environmentally friendly - no mercury
- Time delay to allow for optimum drainage
- Override wire included to allow for manual activation

3 Year Warranty

Tips

It is important to ensure that a vented anti-syphon loop is incorporated in the system



Awards and Accreditations

- Conforms to ISO 8849 and ISO 15083
- Ignition protected per ABYC and USCG standards
- CE certified
- EMC compliant
- NMMA type accepted



COMPLETE YOUR SYSTEM

For bilge system accessories- see page 40-43

YOU MAY ALSO LIKE

Grey IC and Gulley IC – Automatic Grey waste pump kits with automatic intelligent control built in – see pages 86 and 88



Product Information



Model Specifications

Model	Bilge IC	
Product Code	SI8284	SI8484
Voltage	12 V d.c.	24 V d.c.
Voltage Range	10 V to 13.6 V d.c.	21.6 V to 27.2 V d.c.
Recommended Automotive Fuse Size	10 Amp	5 Amp
Minimum Wire Size	1.5 mm ² (16 AWG)	
Cable Length	4m (12ft)	
Current Profile	Soft start / stop	
Weight	2.6kg (6.5 lbs)	
Current Draw on Standby	Low power 0.01 Amps supply	
Maximum Suction Lift	3m (10ft)	
Maximum Discharge Head	3m (10ft)	
Lift/head Combined	4m (12ft)	
Hose Connections	Gulper® IC - Barbed connections, 3/4" (19mm) or 1" (25mm) Strainer IC - 3/4" (19mm)	
Port Orientation	Horizontal (Easily changed to vertical)	
Connectors	IP68, Waterproof Quick Connect 7 way (directly onto Gulper® IC)	
Materials	Pump Head: Glass-filled Nylon, Valves - Nitrile®, Diaphragm: Santoprene®	
Materials in Contact with Fluid	Glass-filled Nylon, Nitrile®, Santoprene®	
Service Kits	AK2050 – Replacement Pump Head (available separately)	
Run on Time	45 seconds	

Performance Data

Suction Lift	0m	0m	1m (3ft)	1m (3ft)
Discharge Head	1m (3ft)	1m (3ft)	1m (3ft)	1m (3ft)
Hose Size	3/4" (19mm)	1" (25mm)	3/4" (19mm)	1" (25mm)
Flow Rate/Minute	300 US GPH (19 ltrs/min)	276 US GPH (17.5 ltrs/min)	270 US GPH (17.4 ltrs/min)	246 US GPH (15.5 ltrs/min)
Current Draw (12 V d.c.)	7.5 amps	8 amps	7.5 amps	8 amps
Current Draw (24 V d.c.)	3.25 amps	4 amps	3.25 amps	4 amps

Note: Maximum vertical lift not more than 3m (10ft)

Note: For wiring advice on your installation, please contact Whale.

NOTE: These specifications are retail items only. For details of our bulk pack range for boat builders and wholesalers

- contact Whale Support

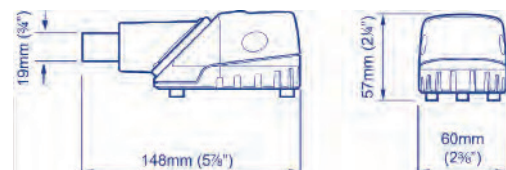

Side View

Front View

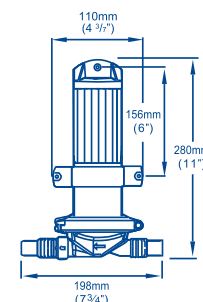

Plan View

Side View

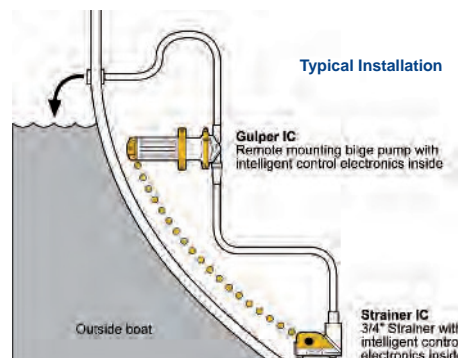

Typical Installation

Supersub Family

Narrow low profile standard submersible bilge pumps now with higher capacity models. Designed for use with separate bilge switch.

Low profile electric bilge pump designed for narrow bilge spaces. Supersubs fit deep down in small / awkward bilge spaces where other pumps won't.

This product is protected by the following granted patents:
United States Patent No. US 6,174,146; and United Kingdom Patent No. GB 2 328 719.



500



NEW 1100

NEW Widest Range Ever

Drains to down 9mm (1/3")

Long term reliability
- comes with extra long wires for integrity

Simple plumbing
- 500 model - 19 mm (3/4")
650 and 1100 models - 25mm (1")
/ 28mm (1 1/8") stepped port
- ports can be rotated to suit your installation

Integrated bleed ball
- prevents airlocks

Efficient operation
- low profile strainer

Easy maintenance
- Unique easy to clean strainer

Versatile installation
- Multi position pump head and body

Product code: see table



Features and Benefits

- Low narrow design for confined bilge spaces
- Easy installation - outlet and pump body rotate to suit your installation
- High performance
- Efficient operation
 - Very low power consumption
- Easy to clean - snap fit assembly
- Low profile strainer
 - Leaves the bilge almost dry

3 Year Warranty

Tips

It is important to ensure that a vented anti-syphon loop is incorporated in the system

Awards and Accreditations

- PBO testers choice

Approvals and Standards

- Conforms to ISO 8849 and ISO 15083
- Ignition protected per ABYC and USCG standards.
- EMC compliant. NMMA type accepted



Product Information

Model Specifications

Model	Supersub 500 (12 V d.c.)	Supersub 650 with Non Return Valve (12 V d.c.)	Supersub 1100 with Non Return Valve (12 V d.c.)	Supersub 1100 with Non Return Valve (24 V d.c.)
Product Code	SS5012	SS5022	SS1012	SS1024
Open Flow Rate @13.6 V d.c.	500 US GPH (32 ltrs/ min)	650 US GPH (40 ltrs/min)	1050 US GPH (66 ltrs/ min)	
Flow Rate at 1M (3ft) head	400 US GPH (25 ltrs/ min)	550 US GPH (34 ltrs/min)	750 US GPH (47 ltrs/ min)	
Nominal Voltage	12 V d.c.		12 V d.c.	24 V d.c.
Current Draw	2.4 Amp		4.3 Amp	2.2 Amp
Recommended Fuse Size (Automotive)	5 Amp		5 Amp	2.5 Amp
Weight	270g (0.6 lbs)		400g (0.9 lbs)	
Hose Connections	19 mm (¾")	25mm/28mm (1" / 1 ⅝") stepped ports	25mm / 28mm (1" / 1 ⅝") stepped ports	
Minimum Wire Size	1.5 mm ² (16 AWG)			
Materials	Pump Body: Polypropylene, High Temperature ABS, Locking Ring: Acetal, Impeller: Glass-filled PBT, Seals: Nitrile®, Fasteners: Stainless Steel			
Materials In Contact With Fluid	Polypropylene, ABS, Glass-filled PBT, Nitrile®			
Accessories (available separately)	Electric bilge switches BE9003 and BE9006 - for all bilge accessories see page 40-43 Non return valve LV1219			

Note: For wiring advice on your installation, please contact Whale.
These specifications are retail items only.

For details of our bulk pack range for boat builders and wholesalers - contact Whale Support.

Please note: flow rates quoted are based on Whale laboratory tests without a non-return valve included.

Note: based on independent comparative submersible 500 GPH models test - Practical Boat Owner (August 2012 issue)

COMPLETE YOUR SYSTEM

See Page 40-43 for bilge system accessories

YOU MAY ALSO LIKE

Supersub Smart Family - The automatic range with built in intelligent control - no need for a separate bilge switch - page 12

Orca Auto 1300 - Compact, powerful and automatic submersible bilge pump - page 14

NEW Bilge IC - Pre-wired Remote Mounted Bilge System with automatic intelligent control built in - page 16

DIMENSIONS FOR 500 MODEL

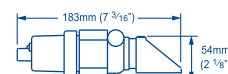

Side View

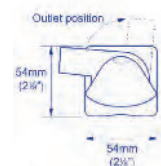

Front View

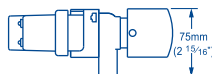

Plan View

DIMENSIONS FOR 1100 MODEL Side View

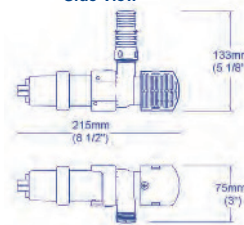

Plan View

Typical Installation

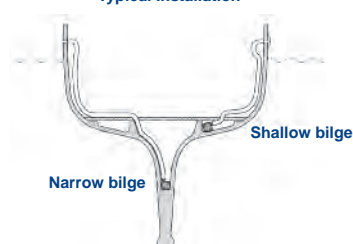

Orca Electric Bilge Range

Orca- Compact and Powerful Electric Bilge Pump Range designed for use with a separate electric bilge switch Whales widest range of electric submersible bilge pumps ever

NEW HIGH CAPACITY MODELS

Efficient design with large footprint to ensure maximum surface area exposure to bilge water, now available in higher capacity 2000 and 3000 models.

Product code: see table

Lowest drain down 8mm / 1/3"

Simple plumbing

500 models - 19 mm (3/4") ports
950, 1300 models - 25mm (1") or 28.5mm (1 1/8") stepped port connections
2000 models - 28.5mm (1 1/8")
3000 models - 32mm (1 1/4")

Easy maintenance
- easy access to motor cartridge and filter

Easy release cover
- simply press both buttons and pull to release

Robust housing
- fuel resistant ABS

Efficiency
- large surface area ensures maximum area exposed to bilge water

Versatile installation
- choose from multiple wire location options



NEW Widest Range Ever



Features and Benefits

- High performance
- Simple installation
 - Multiple wire locations
- Low amp draw means long battery life
- Easy maintenance
 - Access to motor cartridge and filter area
- Compact design
- Available in a range of 5 flow capacities
 - 500, 950, 1300, 2000 and 3000 US GPH
- 2000 and 3000 models self clearing
 - prevent cavitation

3 Year Warranty

Awards and Accreditations

- Meets ISO8849 marine standard
- CE certified

COMPLETE YOUR SYSTEM

Whale high quality bilge accessories including electric bilge switches, non-return valves, elbows and Y pieces. Page 40



BE9002 Floatswitch suitable for use with 12 V d.c. or 24 V d.c. pumps
note: (Up to 15 amp rated 500, 950, 1300 Orca models)



NEW BE9003 Electric field sensor switch suitable for use with 12V d.c. or 24 V d.c. pumps



NEW BE9006 Electric field sensor switch with built-in 30 second time delay suitable for use with 12V d.c. or 24 V d.c. pumps



Product Information

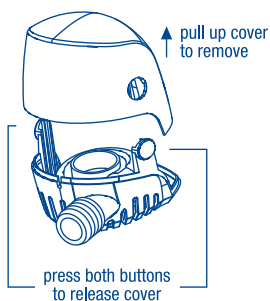
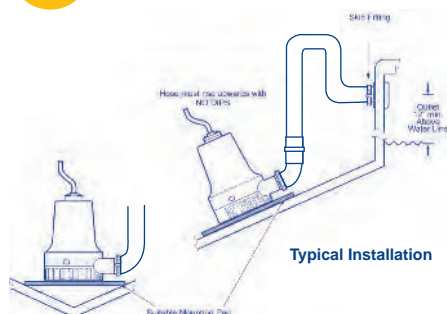

Easy maintenance

YOU MAY ALSO LIKE

Orca Auto 1300 – Compact, powerful and automatic submersible bilge pump- page 14

Supersub Smart Automatic narrow low profile submersible bilge pumps – page 12

Supersub – narrow low profile submersible bilge pumps (designed for use with a separate electric bilge switch – page 18)

Model Specifications

Model	500 US GPH	950 US GPH		1300 US GPH	1300 US GPH	2000 US GPH		3000 US GPH	
Product Code	BE0500	BE0950	BE0954	BE1450	BE1454	BE2002	BE2004	BE3002	BE3004
Open Flow Rate @13.6 V d.c.	500 GPH (32 l/min)	950 GPH (59 l/min)		1300 GPH (82 l/min)		2000 US GPH (126 l/min)		3000 US GPH (189 l/min)	
Flow Rate at 1m (3ft) head	450 GPH (28 l/min)	850 GPH (53 l/min)		1100 GPH (69 l/min)		1650 US GPH (104 l/min)		2700 US GPH (170 l/min)	
Nominal Voltage		12 V d.c.	24 V d.c.	24 V d.c.		12 V d.c.	24 V d.c.	12 V d.c.	24 V d.c.
Current Draw	1.5 amps	3.5 amps	2 amps	5.0 amps	2.5 amps	10 amps	5.0 amps	18 amps	9 amps
Recommended Automotive Fuse	2.0 Amp	5.0 Amp	3 Amps	7.5 Amp	5.0 Amp	15 Amp	7.5 Amp	25 Amp	15 Amp
Weight	0.28 kg. (0.6lbs)	0.45 kg. (1 lb)		0.82 kg. (1.8 lbs)					
Hose Connection	¾" (19mm)	1"/1 ½" (25/28.5mm)		1"/1 ½" (25/28.5mm)		1 ½" (28.5mm)		1 ¼" (32mm)	
Wire Size	1.5mm2 (16 AWG)								
Materials	Pump Body- ABS, Seals: Nitrile®, Impeller: Acetal								
Maximum Discharge Head	3 m (9.8ft)	3.5m (11.5ft)		4.5m (14.8ft)		4 m (13 ft)		4.6 m (15ft)	
Overall Height	83mm (3.3")	109mm (4.3")		129mm (5.1")		165mm (6.5")		195mm (7.7")	
Overall Width	102mm (4")	135mm (5.3")		168mm (6.6")		144mm (5.7")		166mm (6.5")	
Overall Depth	78.5mm (3.1")	103mm (4.1")		121mm (4.8")		120.5mm (4.74")		132mm (5.1")	

Gulper® 320

Easy Access Remote Mount Bilge Pump High, Dry and Protected - remote mounted for easy inspection

No clog, no filter waste pump built on more than a decade of market leading pump technology



Features and Benefits

- Easy Access Remote Mount Bilge Pump – Remote mounting allows easy access
- Meets requirement for primary bilge pump for boats up to 12m (39.4ft) length
- Ideal where bilge space is limited
- Long life high, dry and protected

3 Year Warranty

Awards and Accreditations

- ISO15083 Marine standard suitable as a primary bilge pump (for vessels up to 12m in length) or secondary bilge pump in accordance with ISO8849.
- Ignition protection ISO8846.
- CE marked.

COMPLETE YOUR SYSTEM

See page 40-43 for bilge accessories

YOU MAY ALSO LIKE

Bilge IC - Pre-wired Automatic Bilge System with Intelligent Control built in - page 16

Supersub Smart - Narrow low profile Automatic Electric Bilge Pumps with Intelligent Control built in - page 12



Product Information

Model Specifications

Model	Gulper® 320	
Product Code (retail)	BP2052 (includes 3/4" strainer)	BP2054 (includes 3/4" strainer)
Voltage	12 V d.c.	24 V d.c.
Hose Connections	3/4" (19mm) + 1" (25mm)	
Recommended Fuse Size	10 Amp Automotive	5 Amp Automotive
Minimum Wire Size	1.5 mm ² (16 AWG)	
Weight	1.6 kg (3.5 lbs)	
Materials	Pump Head: Glass-filled Nylon, Valves and Diaphragm: Santoprene®	
Accessories	SB3422 (19mm) strainer (multi-directional port) Service Kit: AK2050 - replacement pump head	
Maximum Suction Lift	3m (10ft)	
Maximum Discharge Head	3m (10ft)	
Maximum Discharge Head and Suction Lift Combined	4m (13.5ft)	

Performance Data

Model	BP2052 / BP2054			
Suction Lift	0m	0m	1m (3ft)	1m (3ft)
Discharge Head	1m (3ft)	1m (3ft)	1m (3ft)	1m (3ft)
Hose Size	3/4" (19mm)	1" (25mm)	3/4" (19mm)	1" (25mm)
Flow Rate per Minute	19 ltrs (5 US Gals)	17.5 ltrs (4.6 US Gals)	17.4 ltrs (4.5 US Gals)	15.5 ltrs (4.1 US Gals)
Current Draw	7.5 amps (12 V.d.c.) 3.25 amps (24 V.d.c.)	8 amps (12 V.d.c.) 4 amps (24 V.d.c.)	7.5 amps (12 V.d.c.) 3.25 amps (24 V.d.c.)	8 amps (12 V.d.c.) 4 amps (24 V.d.c.)

Note: These specifications are retail items only.

For details of our bulk pack range for boat builders and wholesalers - contact Whale Support.

EASY ACCESS FOR INSPECTION

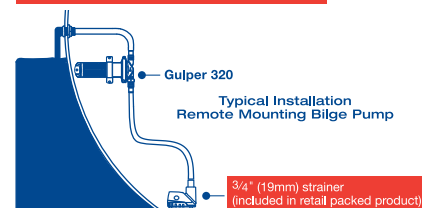

Strainer

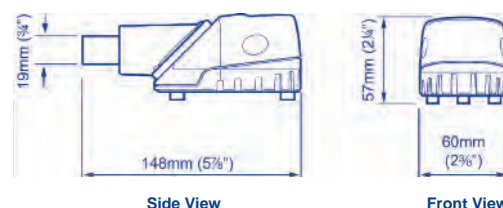

Gulper

